



Wolli Creek Preservation Society

Update

February 2017

wollicreek.org.au

In spite of losing Beverley Grove



WE HAVE SOMETHING TO CELEBRATE!

In December 2016, then Premier Mike Baird made a long hoped-for announcement:

The two hectares of bushland at Bexley North that we have been fighting to preserve will now be transferred over from RMS to NSW National Parks and Wildlife for inclusion in the Wolli Creek Regional Park.



A WIN AT LAST!!

Good news indeed. We expect the first stage of the transfer to the Department of Planning and Environment is to be completed by March. These two hectares will complete the western end of the Wolli Creek Regional Park.

About seventy members, supporters and interested locals turned out for a beautiful morning tea and festivities at Iloura Reserve

“WCPS is very pleased that this transfer is now in the pipeline, as the land has long been promised for the Regional Park,”



WCPS president Deb Little

“COMPLETION OF THE PARK BY 2018 IS NOW OUR AIM”

Many thanks to all those who helped organise the event, carted equipment, made signs, baked cakes, staffed the stalls, played the jazz and came to show their support



SEE MAP OF REGIONAL PARK on PAGE 5

SUNDAY 5TH MARCH

CLEAN UP AUSTRALIA DAY

AT PAPERBARK CREEK 9am - Midday

After all the patient bushcare work that's been done there, Paperbark Creek was looking beautiful.

But a lot of rubbish gets washed from roads and gardens into the creek via the stormwater drain. We also need to remove a sizable blockage of rubbish that threatens the strength of the footbridge.

**WE ARE LOOKING FORWARD TO HAVING AS MANY VOLUNTEERS AS POSSIBLE**

We'll be meeting near the TVT trail sign on the grassy area in Bray Ave, just across from Richard Ave in Earlwood.

Bring sturdy shoes, clothes you don't mind getting dirty, gardening gloves, a hat, sunscreen and water if it's a hot day. Children of school age and older are welcome to help, provided they are accompanied by a responsible adult.

If you can help with cleaning up or bringing food for morning tea, please contact Pat directly on pthomas01@optusnet.com.au or 0417 110 191.

Canterbury-Bankstown Council is actively supporting us again, which is very much appreciated.

REGISTRATION

Online at www.cleanupastraliaday.org.au/register/Paperbark+Creek. Everyone working on site has to be registered but can use the hardcopy register on the day.

Our Facebook page for you to join, like and/or leave a comment: www.facebook.com/events/616664135185140/

COMING UP

FRIDAY 10TH MARCH

SUNSET BATWATCH PICNIC

TURRELLA RESERVE



Come down to Turrella Reserve, bring the kids and a picnic and experience this huge natural event. Over 300 people came for the experience last time and it's a great atmosphere.

Batty activities for kids start at 6.30. The flyout will be after dusk, about 7.45.

The Flying Foxes roost, sleep and socialise during the day in their Turrella Camp, between Wolli Creek and the railway line. Every night at sunset, they fly out in search of nectar, blossom and fruit all over Sydney. Come early if you like and watch them dipping for a drink in the creek. These important long distance pollinators are a protected species, because they are vital to the spread of native plant pollen, yet their habitat is steadily being eroded.

Watch our video of the [last Batwatch Picnic](#)

**WANT TO HELP RUN KIDS ACTIVITIES, LIKE FACE-PAINTING OR BAT CRAFT??**

Last time, volunteers were run off their feet with these highly popular activities
MORE PEOPLE VERY WELCOME

HISTORY IN THE VALLEY

SUNDAY 21 MAY 1.30 - 4pm

50TH ANNIVERSARY OF THE BATTLE FOR NANNYGOAT HILL

TURRELLA RESERVE

Enter via Finlays Ave or Henderson St footbridge



50 years ago local residents won the Battle for Nannygoat Hill

In 1967, local Earlwood residents protested to stop our well-loved landmark becoming airport runway rubble. 'The Battle for Nannygoat Hill' is an integral part of the Valley's history, as shown in the [ABC TV program 'This Day Tonight' from 1967.](#)

We are celebrating how much people continue to care for the Wolli Creek valley bushland.

IF YOU LIKE, COME DRESSED UP IN SIXTIES OUTFITS TO RETRACE THE WALK OF PROTEST UP NANNYGOAT HILL

- Bring a picnic to enjoy in Turrella Reserve
- Children's activities and games
- Walks from Girrahween Park & Jackson Place
- Yarn Spinners tent for the Turrella Talkers and Wolli Walkers
- History tent
- Screening of 'The Battle for Nannygoat Hill'
- Stories about the changing face of Nannygoat Hill and Turrella Reserve
- Have a cuppa at the Turrella Teahouse
- Come along and join the fun

How should we mark this occasion?
Like to organize an event or take part?

Contact Judy Finlason info@wollicreek.org.au

BUSHCARE

GOOD NEWS FOR BUSHCARE TOO STRONGER COMMUNITIES GRANT

Canterbury-Bankstown Council has awarded WCPS close to \$50,000 for building community participation and effectiveness in restoring Wolli Creek Bushland.

"The Stronger Communities Grant will support the work of two of our Bushcare groups - one site for this is the bushland immediately west of Illoura Reserve, the Western Gateway bushland.

The Grant will also help the Society to recruit new volunteers, expand volunteer numbers and target culturally and linguistically diverse groups, such as local Chinese and Arabic-speaking communities,"

WCPS Bushcare Co-ordinator Peter Stevens

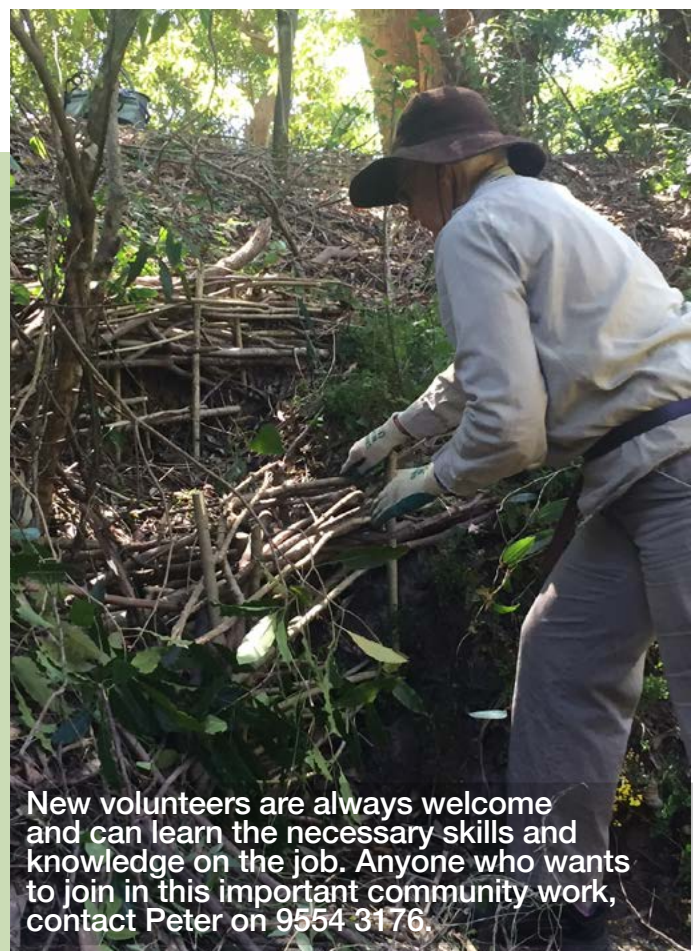

New volunteers are always welcome and can learn the necessary skills and knowledge on the job. Anyone who wants to join in this important community work, contact Peter on 9554 3176.

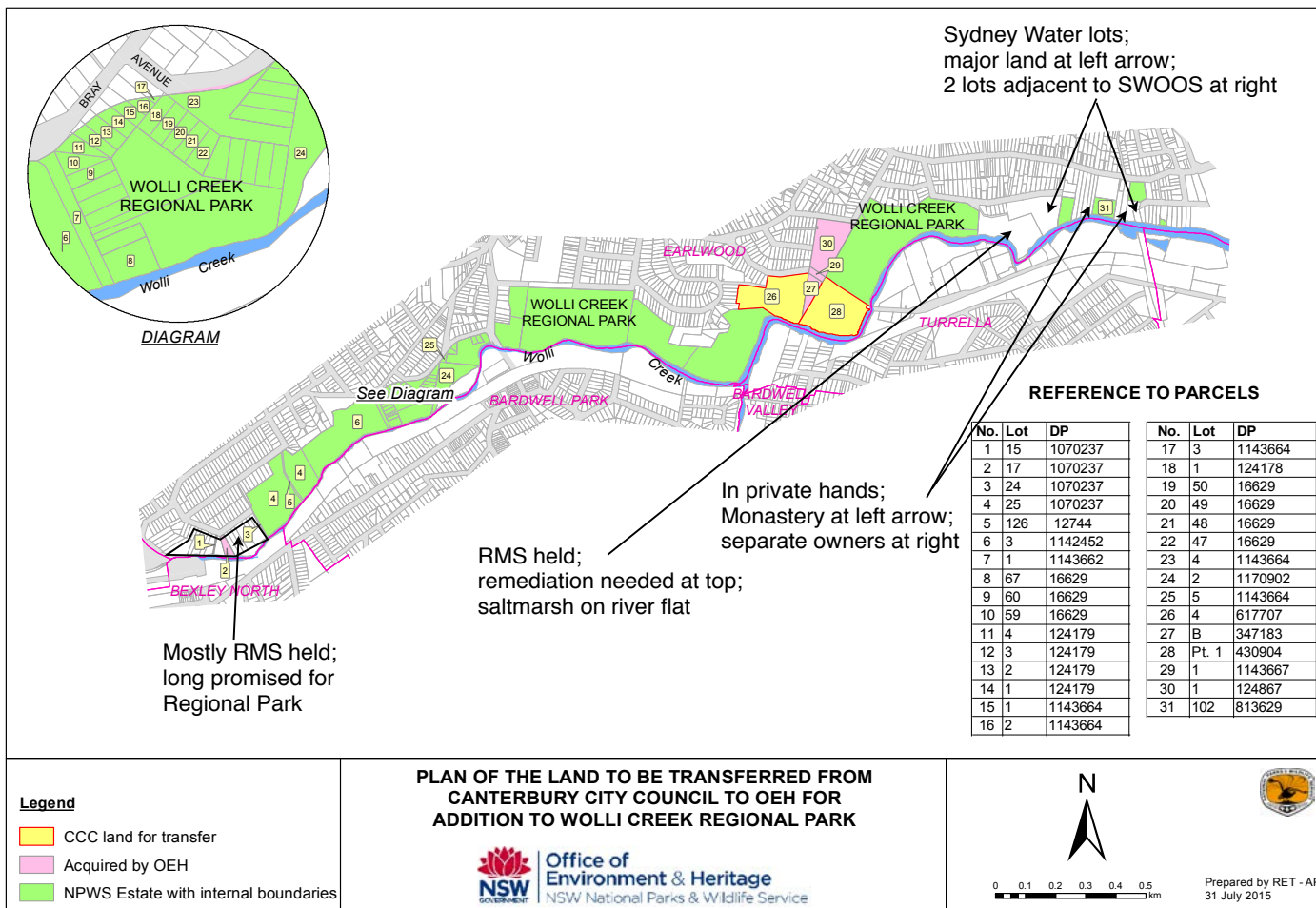

COMPLETING THE REGIONAL PARK

Transfer of the RMS land close to Bexley North is in progress. This will bring the land secured for the Regional Park up to about 95% of the area proposed. The remaining 5% is all at the eastern end of the valley.

RMS is committed to transferring their block but that can't happen until the low-level contamination is remediated. Some of the private blocks are under negotiation already, with more to follow. Sydney Water land remains problematic; under their charter they can only transfer at market value and of course NPWS doesn't have adequate funding.

We will soon be launching a campaign to have the Park completed by 2018, which will be the 25th anniversary of the original proposal by WCPS, which became a (NSW) private member's bill introduced by Clover Moore; it lapsed when Parliament was prorogued that year.

Peter Stevens

In the Valley...

The first Brush Turkey has been sighted in the Valley
Photo by Voren O'Brien



John Duffy recently spotted a Peregrine Falcon near Jackson Place. In 2015, Greg McLachlan took this photo in exactly the same spot

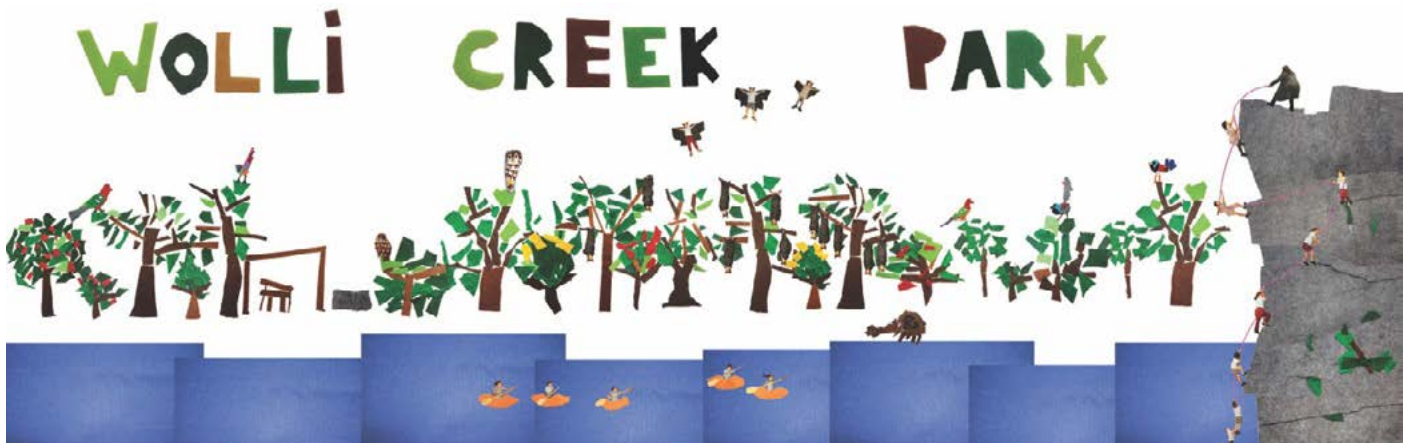

Winners of the RANKIN AWARD

The 2016 Rankin Award was presented at the end of last year to three groups for outstanding programs aimed to foster children's enjoyment and understanding of the natural world.

All recipients of an award received a certificate and donation towards their activities. The preschool children were given a colouring-in certificate and the Athelstane children a bookmark, kindly printed by Lindwall and Wall, Marrickville.



EARLWOOD UNITING CHURCH PRESCHOOL

NPWS Ranger Ben Khan presented the Award



ATHELSTANE PUBLIC SCHOOL ARNCLIFFE

Artist Ken Searle attended the special school assembly to present the Award

MAY MURRAY EARLY CHILDHOOD CENTRE

Peter Munro from the Mudcrabs presented their award



The Wolli Creek Valley OUTDOOR CLASSROOM

- Do you have a child attending a school in the Wolli Creek Valley area?
- Does your school use the Valley as a teaching resource?
- WCPS has developed many teaching resources to support teachers.

If you would like to find out more contact

[info@ wollicreek.org.au](mailto:info@wollicreek.org.au) or visit www.wollicreek.org.au

MEMBERSHIP

Family One Year \$15
Individual One Year \$10
Concession \$7
Group Membership \$30

Direct Deposit Westpac BSB 032 067
WCPS Inc 288295, with your
SURNAME and RENEW in
the information line

Email info@wollicreek.org.au to confirm
years and any donation included



Kunzea in flower

JANUARY BLOSSOMS IN THE VALLEY

Bursaria in flower



EDITOR & LAYOUT: LAURA ZUSTERS

CALENDAR

Bush Regeneration: Feb 4, 8, 12, 17, 18, 25. Mar 4, 8, 12, 17, 18, 25. Apr 1, 9, 12, 14, 15, 22. May 6, 10, 14, 19, 20, 27. Get details of locations via bushcare@wollicreek.org.au, from WCPS website calendar or phone 9554 3176. Always check in case of changes at short notice.

Bat Counting: Generally, third Friday of each month, just after sunset. For up-to-date details, join the bat group email list by contacting bats@wollicreek.org.au and come along to see the fly-out or join in the counting

Bird Surveys: Ten teams are doing regular monthly surveys of bird species and numbers present. They work to their own timetable, but we can get you involved on a team if you contact birds@wollicreek.org.au

Committee Meetings: Feb 13 (special planning meeting), 27, Mar 27, Apr 24, May 22. Inner south-west CDO, Suite 1, Ground Floor, 11-13 Hartill-Law Ave Bardwell Park. All members are welcome to attend the meetings, notification to WCPS essential due to security at the building.

Kayak Trip: Wolli Creek to Crest: From River Canoe Club, on Cooks River, Tempe. For enquiries about next trips or to register, contact info@wollicreek.org.au. Book early to avoid disappointment.

Celebrating Gains for Wolli: Sun, February 19, 10:30am to 12:00 at Illoura Reserve, Earlwood. Light refreshments, jazz band, informal family activities, cutting of celebratory cake.

Clean Up Australia Day: Sunday 5 March, 9 am to 12 noon. Come and help us make the Wolli Valley look even better. See this issue for registration and more details.

Sunset Bat Watch Picnic: Friday March 10. From about 6 or 6:30pm. Enjoy the amazing sight of our Wolli bats, the Grey-Headed Flying Foxes flying out at dusk over Turrella Reserve, while sharing a picnic with family and friends. Invite your neighbours too!

50th Anniversary of Battle for Nanny Goat Hill – Sat 13 May – Picnic, special walk and other activities.

Wolli Valley Walk: From Bexley North to Tempe. Sunday 9 April Book with Ute 0424 646 877

To register info@wollicreek.org.au

Wolli Creek Preservation Society
PO Box 270 Earlwood NSW 2206
E info@wollicreek.org.au
FB Protect Wolli Creek Valley
www.wollicreek.org.au

